

# BLOOM TOWNSHIP SECTION 24 R12 TWP 11 MORGAN COUNTY, OH

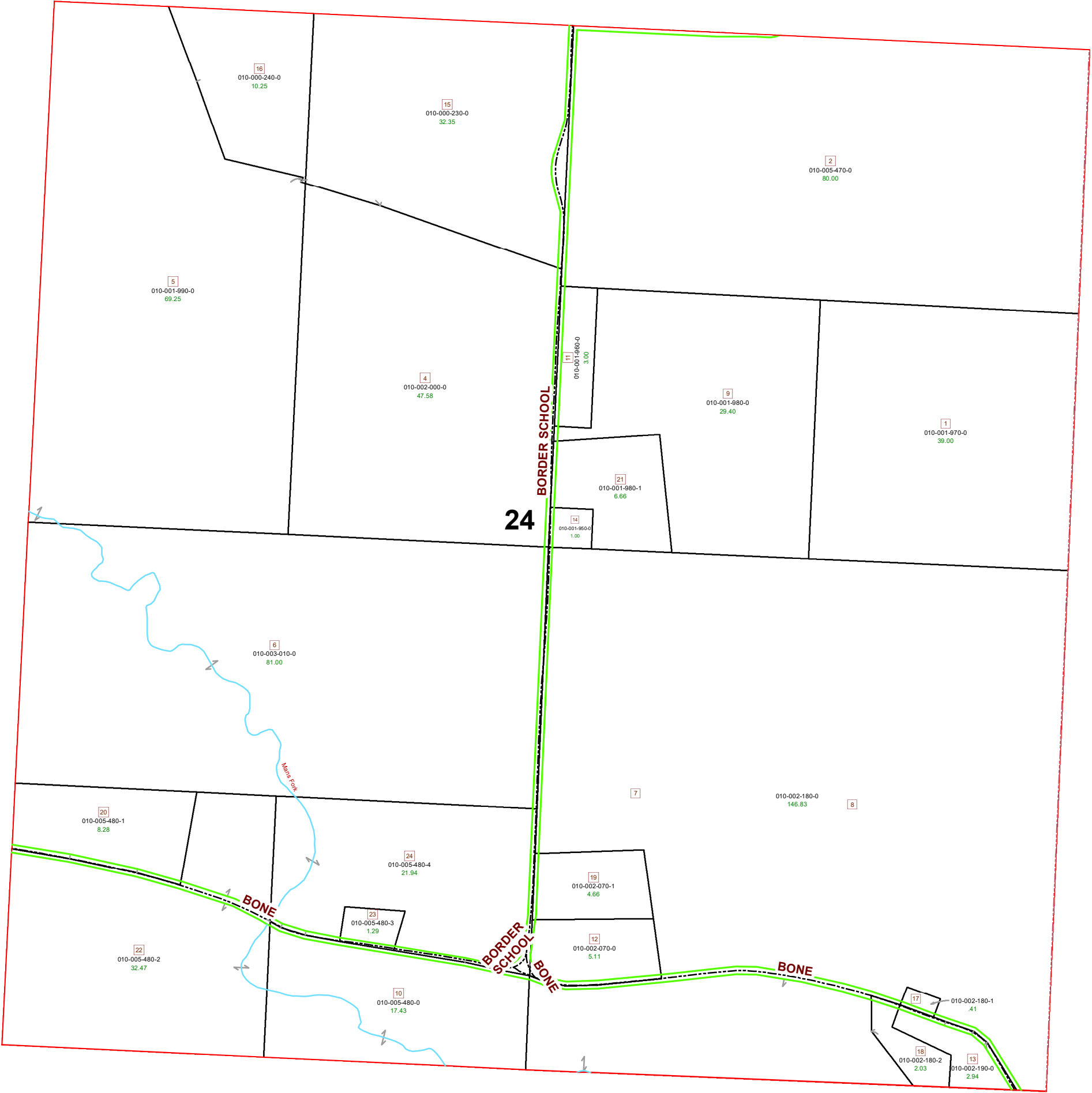

PIN	VOL	PAG	Owner	LegalDescr	Acres
010-000-230-0	D.V. 168	613	BAILEY RANDY & CHERYL	R12 T11 S24 SD 15	32.35
010-000-240-0	D.V. 16	613	BAILEY RANDY & CHERYL	R12 T11 S24 SD 16	10.25
010-001-950-0	OR96	436	GIBEAUT MATTHEW B	R12 T11 S24 SD 14	1
010-001-980-1	OR96	436	GIBEAUT MATTHEW B	R12 T11 S24 SD 21	6.665
010-001-970-0	OR202	427	GIBEAUT MATTHEW B	R12 T11 S24 SD 1	39
010-001-980-0	OR202	427	GIBEAUT MATTHEW B	R12 T11 S24 SD9	29.405
010-001-960-0	OR202	427	GIBEAUT MATTHEW B	R12 T11 S24 SD 11	3
010-002-000-0	OR202	427	GIBEAUT MATTHEW B	R12 T11 S24 SD 4	47.58
010-001-990-0	OR202	427	GIBEAUT MATTHEW B	R12 T11 S24 SD5	69.25
010-002-180-0	OR226	1058	GREER ANGUS FARM LLC	R12 T11 S24 SD 7-8	146.82
010-002-070-0	OR131	617	GREER D BRENT & LINDA SUE	R12 T11 S24 SD 12	5.114
010-002-070-1	OR31	759	GREER JAY B & MICHELLE L	R12 T11 S24 SD 19	4.666
010-002-190-0	OR226	1058	GREER JOHN D & DENISE L	R12 T11 S24 SD 13	2.94
010-002-180-2	OR226	1058	GREER JOHN D & DENISE L	R12 T11 S24 SD 18	2.034
010-002-180-1	OR34	64	GREER JOHN D & DENISE L	R12 T11 S24 SD 17	0.417
010-003-010-0	OR226	1365	KELLY FAMILY TRUST & DONALD WILLIA	R12 T11 S24 SD 6 S	81
010-005-480-1	OR146	720	KELLY REBECCA A	R12 T11 S24 SD 20	8.289
010-005-480-2	OR214	627	MORBITZER FAMILY LLC	R12 T11 S24 SD 22	32.474
010-005-470-0	OR224	2650	STAIB DONALD E & SHARON A TRUSTEES	R12 T11 S24 SD 2	80
010-005-480-0	OR233	1541	STEVENS MICHELLE L	R12 T11 S24 SD 10	17.43
010-005-480-3	OR233	1541	STEVENS MICHELLE L	R12 T11 S24 SD 23	1.29
010-005-480-4	OR233	1541	STEVENS MICHELLE L	R12 T11 S24 SD 24	21.94

**Boundaries**

- Lot
- ROW
- Section
- - - Hidden
- Symbols
- Roads
- Sections
- Parcels

Disclaimer: The Information that these maps contains is for reference purposes only. Please bring any errors to the attention of the Engineer's Office staff. Thank You

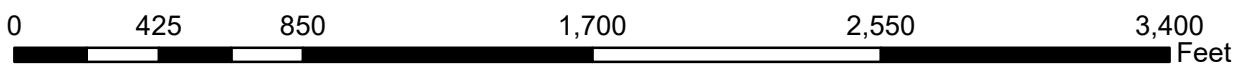

Morgan County Engineer's Office  
 Author: Marcia Wolfe  
 Date: 7/20/2020